

GENERAL NOTES:

- THE CONTRACTOR IS NOTIFIED OF THE EXISTENCE OF UNDERGROUND ELECTRIC LINES SERVING OUTLETS NEAR BASES OF TREES. THE CONTRACTOR SHALL COORDINATE WITH THE CITY. PRIOR TO CONSTRUCTION, DETERMINE THE LOCATION OF THE UNDERGROUND ELECTRIC LINES. SHOULD THESE LINES BE DAMAGED DURING THE INSTALLATION OF THE WALKWAY, THE CONTRACTOR SHALL CONTACT SARAH NEUTS, PARKS OPERATIONS MANAGER AT 161-1610 EXT. 1803 FOR REPAIRS. THE CONTRACTOR IS NOT RESPONSIBLE FOR THE LINE REPAIRS.
- CONTRACTOR IS RESPONSIBLE FOR REPAIRING ANY DISTURBED AREAS WHICH RESULT FROM THE CONSTRUCTION ASSOCIATED WITH THE SHORELINE STABILIZATION.

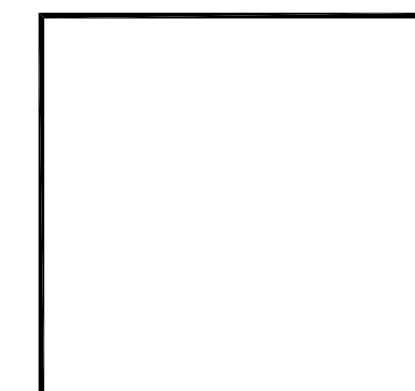
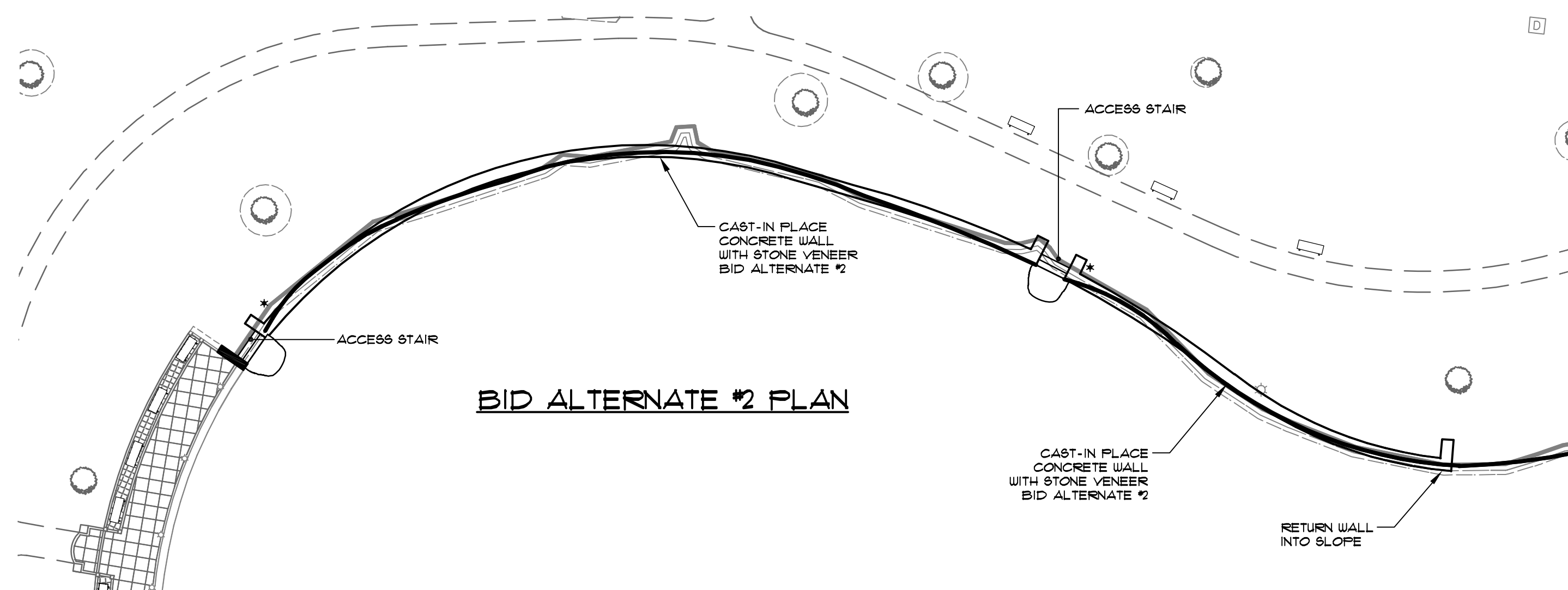
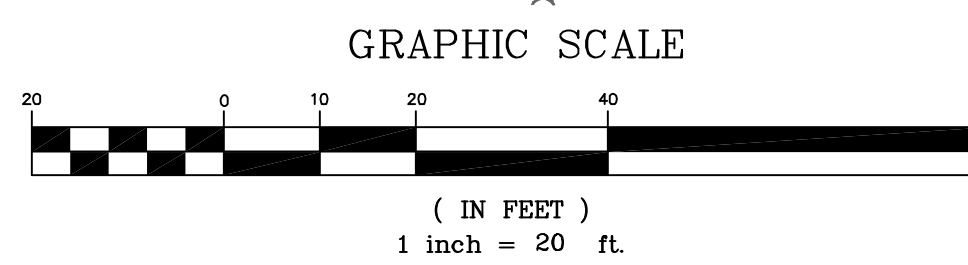

ADDENDUM 2	2-27-15	RLM	BY:	STATUS:
	2-9-15	RLM	DATE:	ISSUED FOR BID

PROJECT NO.	09361
FIELD BOOK	88542
DESIGN	SGD
CHKD	RLM
DRAWN	JAR

WWW.SEBAGOTECHNICS.COM
75 John Roberts Rd. - Suite 1A - South Portland, ME 04106
Tel: 207-783-2100

95 John Roberts Rd. - Suite B Lewiston, ME 04240
Tel: 207-783-5888

THIS PLAN SHALL NOT BE MODIFIED WITHOUT WRITTEN PERMISSION FROM SEBAGO TECHNICS, INC. ANY ALTERATIONS, AUTHORIZED OR OTHERWISE, SHALL BE AT THE USER'S SOLE RISK AND WITHOUT LIABILITY TO SEBAGO TECHNICS, INC.

DATE	09-23-14	SCALE	1" = 20'
------	----------	-------	----------

SITE PLAN AND DETAILS

OF:
MILL CREEK PARK
61 COTTAGE RD
SOUTH PORTLAND, MAINE
FOR RECORD OWNER:
CITY OF SOUTH PORTLAND
P.O. BOX 9422
SOUTH PORTLAND, ME 04116-9422

SEBAGO TECHNICS

SHEET 1 OF 6

09361S-dwg. TAB: S